

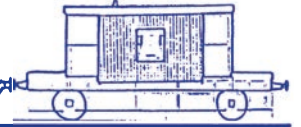

# TRACTION & ROLLING STOCK



No 159 Aug - Sept 2025

## ADVERTISER

[www.tractionads.co.uk](http://www.tractionads.co.uk)

**200**  
Years of Train Travel  
Since 1825

Skerne  
Bridge



**STOCKTON & DARLINGTON  
RAILWAY ROUTE 1825**

## TRAINWEIGH

TRAIN WEIGHING SYSTEMS

*PART OF THE WEIGHBRIDGE SERVICES GROUP*



- Sale and Hire available
- Prevent Derailment
- Monitor wheel imbalances
- For Freight, depots and/or workshop environments
- Portable or fixed systems
- Static or dynamic weighing
- Accuracies as high as 0.02%



**Tel: +44 114 321 63 64**

**Email: [trainweigh@weighbridgeservices.com](mailto:trainweigh@weighbridgeservices.com)**

**Web: [www.trainweigh.com](http://www.trainweigh.com)**



## ALUMINIUM WINDOWS

**Kellett  
Engineering  
Company  
Limited**



Jasper Street Works, Queens Road, Halifax HX1 4NT



Since 1946 Kellett have been designing & producing a wide range of quality framed aluminium windows for trains, locos, and many other varieties of commercial, industrial vehicles and buildings.

Please contact us, see below for details :-

**[www.kellettwindows.co.uk](http://www.kellettwindows.co.uk)**

[sales@kellettwindows.co.uk](mailto:sales@kellettwindows.co.uk)

tel 01132 639041 or mobile 07445 425228

Victoria Inman (Managing Director)

### **Graham Morris Engineering Ltd**

New boilers designed and approval obtained.  
Steam locomotive boiler inspections undertaken.  
Diesel locomotive air reservoirs examined in situ.

**Graham Morris** BSc, CEng, MIMechE  
01327 872148, [graham@gmel.co.uk](mailto:graham@gmel.co.uk)

### **1994 Case 688 RRV For Sale**



Rail wheel braking conversion 2013  
Fitted with Prolec Liftwatch 5 RCI system  
Circa 15000 hours recorded.  
In working condition but no current LOLER cert.  
£9500 plus VAT  
All enquiries to  
[paul.ingram@svrlive.com](mailto:paul.ingram@svrlive.com)

### **2' Gauge rail for sale**

(approx.. 20lbs / ft) 45 x 36 ' lengths. + Points.  
Details

[Sales2025@thebrickworksmuseum.org](mailto:Sales2025@thebrickworksmuseum.org)

**Class 11 on the Aln Valley Railway crosses the  
historic Cawledge Viaduct June 2025.  
Worlds oldest railway masonry viaduct.**

ALL P PROFILES, UIC, CHIEFTAIN & BESPOKE



## **RAIL WHEEL PROFILE GAUGES**

*Maximise your rolling stock's life span  
with a certified profile gauge from our fully equipped CNC workshop.*

We manufacture gauges for all **standard profiles**, **wheel diameter gauges**, and **bespoke profiles** from customer drawings.

All gauges supplied with a **certificate of calibration**.



**CONTACT US FOR PRICES**  
01827 839468  
[nick@statfold.com](mailto:nick@statfold.com)



**HALLETT  
STEAM OILS**

SUPPORTING HERITAGE STEAM

**Specialists in Heritage and  
Steam Locomotive Lubricants**

STEAM CYLINDER OILS • STEAM BEARING OILS  
DIESEL LOCOMOTIVE OILS • SPECIALIST PRODUCTS

T: +44 (0) 1246 823007 E: [sales@aztecoils.co.uk](mailto:sales@aztecoils.co.uk)

**[www.hallettoil.co.uk](http://www.hallettoil.co.uk)**





# Wanted

Double ended veranda style brake van  
BR Class 121 (bubble car)

Wooden cattle wagon

Flat bed wagon

Fuel or oil tanker

Any condition considered.

Contact Steve on 07780 330600

stephen.dunn60@icloud.com

## **SUTTON CASTINGS**

BRASS, BRONZE,  
ALUMINIUM AND IRON  
SAND CASTINGS

**Sutton Castings,**  
Oxton, Nottinghamshire.  
(by appointments only)

07527 851645

suttoncastings@yahoo.com

[www.suttoncastings.co.uk](http://www.suttoncastings.co.uk)

We do general engineering castings to include the following for the steam preservation

Cylinder blocks, Brake Blocks,  
Shaft and Axle bearings, Firebars,  
Chimneys, Wheels, Pistons,  
Steam valves & boilers fittings,  
Namlates, Architectural posts and  
bollards. CNC &  
traditional pattern making.



Materials to include, All grades of  
grey iron, Copper based alloys and  
Aluminium alloys

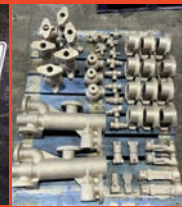

**TREFOIL STEEL Co Ltd**

TINSLEY SHEFFIELD S9 1QQ

Ph 01709 830701 Fx 01709 830737

e-mail [info@trefoilsteel.com](mailto:info@trefoilsteel.com)

**SUPPLIERS TO THE RAILWAY INDUSTRY**

Patterns, Castings and Machining Supplied.

In small to medium batch quantities.

[www.trefoilsteel.com](http://www.trefoilsteel.com)

# The Light Railway Engineers

ESTABLISHED OVER  
**50**  
YEARS

**FROM THE HISTORIC TO THE LATEST  
ZERO-EMISSION E-LOCOMOTIVES  
WE ARE THE NARROW-GAUGE EXPERTS**



## Unrivalled for expertise, service & back-up

From the latest battery & diesel locomotives & carriages, to historic restoration projects; we can maintain and supply spares as well as be on-site when you need us for servicing, surveying, design & track laying.

Whatever your narrow-gauge project, talk to us for the friendliest expert advice, service and uncompromising back-up.



**Alan Keef Ltd**

Call - 01989 750757

Email - [sales@alankeef.co.uk](mailto:sales@alankeef.co.uk)

Or visit [www.alankeef.co.uk](http://www.alankeef.co.uk)

## Higham's Heritage Engineering

We are a family-run business, specialising in  
Heritage Engineering;

We offer a range of services to suit the requirements of  
Heritage Railways and Traction Engine Owners.

Our services are;

- \*Fitness to run exams
  - \*Boiler/Air receiver inspections in line PSSR 2000
  - \*Locomotive Repair/maintenance,
  - \*Carriage repairs/maintenance,
  - \*Covering Steam or Diesel at competitive rates
- for information contact Matthew Higham



07864825773

[www.highamsheritageengineering.co.uk](http://www.highamsheritageengineering.co.uk)





## Railway Wheelset & Brake Ltd

Suppliers of Railway Axles, Wheels, Tyres  
& Heritage Rail Components

### Introducing our expanding range of carriage and wagon components



Overhaul kits for all sizes  
of Vacuum Cylinder &  
Associated Valves



Vacuum Brake Hose  
To any required size



Huge selection of Vacuum  
Cylinder components



Steam Heat  
components



Vacuum Brake  
components

### Bespoke Items

- Complete Vacuum Cylinders
- Passenger Communication Valves
- Dummy Couplings
- Guard's Brake Valves
- Release Valves
- and many more.

### Brake Blocks & Air Brake Components

We are also suppliers of a variety of Brake Block  
types and UIC Air Brake Components.



### Contact

Don't forget to check out our catalogue on our website!

[sales@railwaywheelset.co.uk](mailto:sales@railwaywheelset.co.uk) - 0114 303 0705 - [www.railwaywheelset.co.uk](http://www.railwaywheelset.co.uk)

## PISTON RINGS <sup>UK</sup> LTD



Supplier of Piston and Valve rings to the heritage Locomotive sector.  
Trusted since 1877, Piston Rings UK was known as Lockwood & Carlisle.  
Now partnered with Riley and Sons & the official supplier of rings on  
the world-famous Flying Scotsman, so you can be assured of our quality.

We specialise in low volume, custom built rings to suit your requirements.  
We can offer design and technical input to make sure you get the correct solution  
for you needs. We prioritise customer service as a core value, which our  
existing customers would be happy to recommend.

Contact Simon & the team at Piston Rings UK for a free quotation today.

01709 820 007 07749 5555 40 [sales@pistonrings.co.uk](mailto:sales@pistonrings.co.uk)

Lockwood & Carlisle Daros Industrial Rings UK Standard Piston Rings



Piston Rings UK Ltd, Unit 5 Coggin Mill Way, Rotherham, S60 1FB



NJR ENGINEERING LIMITED

TEL: 01536 263211

[sales@njrengineering.co.uk](mailto:sales@njrengineering.co.uk)

[www.njrengineering.co.uk](http://www.njrengineering.co.uk)

Nuts, bolts & specialist fixings in all thread forms  
including Whitworth. Parts manufactured from  
drawings or reverse engineered from existing  
components with full 3D drawings if required. Manual  
through to full CNC lathes and machining centres.



PRIORS HAW ROAD, CORBY, NORTHANTS. NN17 5PH



### FOR SALE

Newly made BR Mark I seat spring bases to original design.  
These are a straight swap for original life expired units at a  
reasonable price.

Upholstery services offered

Contact Aaron Marsden –  
[a.marsden@EBAR.org.uk](mailto:a.marsden@EBAR.org.uk)

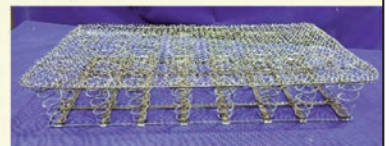

EMBSAY & BOLTON ABBEY

STEAM RAILWAY



## Tested Spring Co Ltd

Round, square & rectangular section springs for  
**Locomotives, Carriages and Wagons.**  
Suspension, Buffers, Valves, Piston glands & doors  
etc. call

Mark Woodward

Phone **0121 557 2308**, Fax **0121 557 4031**

Visit or leave an enquiry at  
**[www.testedspring.com](http://www.testedspring.com)**



## Original and Genuine **MOTOR RAIL SPARES**

and Information

We are delighted to have taken over from Alan Keef Ltd. all the original parts, drawings and patterns for Motor Rail Simplex Locomotives. Many parts are available for immediate delivery. Please visit our web shop or enquire for further information, stating your locomotive and part number.

**[www.motorrailspares.co.uk](http://www.motorrailspares.co.uk)**  
**[enquiries@motorrailspares.co.uk](mailto:enquiries@motorrailspares.co.uk)**

Telephone:  
John - 07748 772873

## Tramcars on offer

**National Tramway Museum, Crich, Derbyshire**



Halle an der Saale electric tramcar 902. Built 1969, last operated 2007. Blackpool Corporation Transport Works Dept. 2



'Railgrinder', built 1935. Non-operational, no truck. Both offered free of charge, recipient to cover transport.

Expressions of interest to [kate.watts@tramway.co.uk](mailto:kate.watts@tramway.co.uk)



## Rail Equipment-Analogue & Digital Meters

Including audible warning systems, pressure and temperature equipment, manufactured/maintained.

Units 8-9, Genesis Business Park, Midland Way, Nottingham, NG7 3EF

Tel 0115 978 5333 Fax 0871 750 2387

[Sales@trentinstruments.co.uk](mailto:Sales@trentinstruments.co.uk)

**[www.trentinstruments.co.uk](http://www.trentinstruments.co.uk) & [www.reauk.com](http://www.reauk.com)**



**Check the web sites**



34050 on the  
Mid Norfolk Railway  
at Thuxton July 25



## Precision Engineers John Dunn Engineering

All types of machine shop work undertaken  
*Parts manufactured and repaired*



Contact us for details of our  
Westinghouse Type 'W' air-brake valve seal kits

Tel: 01430 - 424957 Find us on Facebook  
Email: [theworks@johndunnengineering.co.uk](mailto:theworks@johndunnengineering.co.uk)  
[www.johndunnengineering.co.uk](http://www.johndunnengineering.co.uk)



Sale of BG mk1 coach No.  
6390 from Class 20189 LTD

- On B4 bogies with fairly good tyres.
- Has been recently rust-proofed - hence the patches in the paintwork.
- Intercity livery paints included in the deal.
- Air brake, handbrake and guard compartment in working order.
- Interior in good condition
- Connections for ETH and mains electric fitted.
- Gangways have been removed and welded for security to prevent break-ins.



All queries sent to;  
[Michaelowen2347@gmail.com](mailto:Michaelowen2347@gmail.com)

Located at Swanick, Midland Railway Centre - Butterley.  
Valued at £10k.

## HERITAGE MOTION CORKS

Vented & non-vented  
many sizes catered for.

UK made

Contact,

Tristan 07765 666444

[tristanbishopsmit@gmail.com](mailto:tristanbishopsmit@gmail.com)  
[www.heritagemotioncorks.co.uk](http://www.heritagemotioncorks.co.uk)



### AD Castings Ltd

Specialising in various grades of  
bronze, aluminium and brass.

Pattern making services available with  
a very quick and efficient turn around.

**Bronze castings suppliers to Flying Scotsman**

Wellington Mill, Bolton Rd, Blackburn  
BB2 3PZ 01254 59577

[www.adcastings.co.uk](http://www.adcastings.co.uk)



## CRAFTMASTER PAINTS

The UK's Leading  
Heritage Paint Supplier

Supplying traditional Coach  
Enamel in authentic colours to  
preserved railways nationwide.

Discounts available for Railways,  
Heritage Groups and Engine  
Owners. Please contact us for a  
pricelist.

01954 231 308

[www.craftmasterpaints.co.uk](http://www.craftmasterpaints.co.uk)

[info@craftmasterpaints.co.uk](mailto:info@craftmasterpaints.co.uk)



## CLASS 08 SPARES

Details

[andrew.smart@hunsletengine.co.uk](mailto:andrew.smart@hunsletengine.co.uk)



# YOUR ONE STOP SHOP FOR PARTS AND ACCESSORIES



# WWW.HERITAGESTEAMSUPPLIES.CO.UK

e-mail: [sales@heritagesteamsupplies.co.uk](mailto:sales@heritagesteamsupplies.co.uk)

tel: 01489 570737

\*Inc VAT & UK Mainland only. Maximum Shipment weight 30kg  
Applies to Online orders only. Unless otherwise stated all prices exclude VAT | E&OE.



# 12LDA28-C Power Unit FOR SALE

**Sulzer 12LDA28-C  
Removed from a  
Class 47**

**Located near Derby**

**All Offers Considered**

Contact Charlie  
on 07775 896 498  
[charlie@mclarenrail.co.uk](mailto:charlie@mclarenrail.co.uk)



## **Heritage Transport Supplies Ltd.**

01509 219725 or 07798 916115. E mail – [martynhts@btinternet.com](mailto:martynhts@btinternet.com)

### **SAFETY MANAGEMENT SYSTEMS.**

I can advise on, prepare or audit Safety Management Systems (SMS) and Competency Management Systems (CMS). I specialise on the training and assessing of Safety Critical (SC) staff. I have an extensive portfolio of this type of work and I cover a very wide range of heritage railways, standard and narrow gauge, plus some commercial railway operations and new build loco projects. Please call me to discuss your specific requirements.

### **FOR SALE – STANDARD GAUGE.**

Ex S & L Manning Wardle 0-6-0ST loco number 1762 of 1910 "Dolobran". Half way through a very extensive overhaul. Can be viewed by appointment only at the GCR(N) Ruddington. A rare opportunity to acquire a versatile and powerful 0-6-0 locomotive with 16" x 22" cylinders. The loco has all its components is at the rolling chassis stage of restoration.

Large quantity of **Oerlikon air brake valves** and fittings – believed to have come off long since dismantled  
Harsco Rail grinders and stone blowers.

### **Dogfish ballast hopper wagon.**

Vacuum braked. Body needs some re-plating work. Can be viewed by appointment. £4,000.



Can be viewed by appointment.  
Offers invited.



## BUFFERS WANTED as per the photo or similar



Please contact  
Steve on  
**07780 330600**

## BV8 RH Turnout on Timber

new and unused. £47.5k ono  
As per standard RE/PW/636 drawing.

**PROTECH**



Contact Dan 07502 377913  
[daniel.rivers@protechrail.co.uk](mailto:daniel.rivers@protechrail.co.uk)

## HARE ENGINEERING LTD

ITEM NO.	PART NUMBER	DESCRIPTION	QTY.
1	Cast iron bearing plate 110x110x10		1
2	Cast iron bearing plate 110x110x10		1
3	Cast iron bearing plate 110x110x10		1
4	Cast iron bearing plate 110x110x10		1
5	Cast iron bearing plate 110x110x10		1
6	Cast iron bearing plate 110x110x10		1

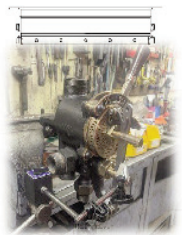
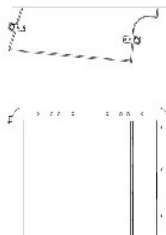
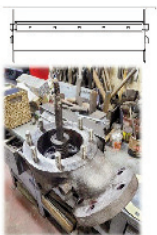
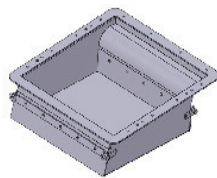

### SERVICES AVAILABLE

- BEARING SCRAPING
- WHITEMETALLING
- MACHINING
- FABRICATION AND REPAIR
- ON SITE MAINTENANCE SERVICES
- COMPONENT OVERHAULS
- CAD AND DESIGN SERVICES
- AGRICULTURAL REPAIR AND MAINTENANCE SERVICES
- RIVETING
- BOILER WORK

**HARE ENGINEERING  
COMBINING HERITAGE SKILLS  
WITH MODERN ENGINEERING  
PRACTISES TO ACHIEVE  
QUALITY RESULTS**



Contact, [hareengineering@gmail.com](mailto:hareengineering@gmail.com)  
Or call 07711211422  
[instagram@hareengineering](https://www.instagram.com/hareengineering)

## SPECIALIST SIGNAGE, CASTINGS & METALWORK FOR THE RAIL INDUSTRY

TRUSTED BY THE UK  
RAIL SECTOR FOR  
**40+ YEARS**



**Leander Architectural** continues to supply the UK rail industry with robust, elegant, custom-made signage solutions, castings and specialist fabrications, from our own foundry and workshop.

- Named supplier for cast bridge ID plates
- Cast columns & structural metalwork
- Network Rail compliant safety signage
- Bespoke fabrication & custom castings
- Signage & Metalwork refurbishment
- Wayfinding & interpretation panels
- Noticeboards & display frames



01298 814941  
[sales@leanderuk.com](mailto:sales@leanderuk.com)  
[www.leander-rail.com](http://www.leander-rail.com)

Manufactured in the UK | Heritage Restoration Experts  
Hallsteads Close, Buxton, Derbyshire, SK17 8BP



## TRACTION & ROLLING STOCK ADVERTISER

Sent out FREE to Heritage Railways, Industrial Railways, Tram & Metros Systems also most Main Line Railways in the UK and their contractors or agents. Produced every two months, acting as a trade directory for Managers, Engineers and decision makers as a handy reference.

Published the first week of Feb, April, June, Aug, Oct & Dec.

All adverts go onto our site [www.tractionads.co.uk](http://www.tractionads.co.uk)

B&W, vehicles, parts and services start at £45 (double column width) 3cm depth

Editor, Ray King. Admin, Davina King. Website hosted by Datatech DTP. Phone **07768 857189**

Post **PO Box 405 Diss Norfolk IP22 9DX**

**ADVERTS FOR THE NEXT ISSUE 26th Sept 2025**

\*The details advertised in this publication have been supplied by the advertisers and Traction & Rolling Stock Advertiser cannot guarantee the details or the ownership of any vehicles or parts advertised. It is the responsibility of the reader to Independently check the quality and accuracy of services advertised. Data protection.

We hold the minimum amount of personal data for the purposes of sending our advertising paper to people interested in railways. We do not share any personal data with any third party. Any named person receiving this paper who wishes their name removed from our records please phone, email or write to the above address. We do not normally send to individuals home address unless requested, by society chairman or other railway officials.

**Free heritage railway vehicle linage adverts**

### **Fides N.D.T Services Ltd**

Provides a comprehensive range of non-destructive testing services, including ultrasonic inspections, magnetic particle and dye penetrant inspections, visual weld inspections, and welder qualification tests, primarily serving heritage railways and traction engine sectors across the South of England and Wales, with contact details available for further inquiries.

Dave Adde Eng.Tech, AMinstNDT, LEP, AWeldI. CSWIP 3.1, CSWIP-BGAS Level 2 Paint Inspector

[fidesndtservices@outlook.com](mailto:fidesndtservices@outlook.com) or **07719550447**

*Based in Southampton, Hampshire*

### **STEAM LOCOMOTIVE WATER TESTING**

- Remote Testing
- Record-keeping
- Results, Feedback and Guidance



Contact Jack (email):

[boilerwatertestservices@outlook.com](mailto:boilerwatertestservices@outlook.com)

### **Class 47/57 spares**

Some new.

Engines/Generators/Turbos/Pistons/Rods/turbos/cylinder heads/Cubicles complete.

Rad elements. Bogies complete /springs (new).

Some brand new parts ex EEC stock or DRS.

Class 57 parts also power packs (new)

Possible swap for class 25/27/33 parts.

No tyre Kickers or short armed deep pocketed individuals, No mithering Journalists or internet.

'I need to know first ' wafflers please.

No schoolchildren.

**Harry 07917 777 871**



Western Champion at Highley May 25



## 143 FLEET FOR SALE

Due to amended strategic future plans we offer for sale 3 units consisting of

143601 the iconic first of its kind,  
ex TfW 143616 ex TfW  
143619 ex GWR

Offers above scrap considered, we would prefer to sell as a complete package but would consider separating subject to reasonable offer.

Also for sale:-

Large quantity of for 143s spares  
inc 3 wheel sets, Spare engine  
and Spare gearbox.

Purchasing the fleet will give you priority in negotiating to purchase the spares.

Happy to negotiate a price for the purchase of all of the above  
For further details or to arrange an inspection visit please contact

Mark at TVLR

[mark@tanatvalleyrailway.co.uk](mailto:mark@tanatvalleyrailway.co.uk)

01691 780042



## Items FOR SALE at the ECCLESBOURNE VALLEY RAILWAY

### Bar Car "Sheila" £24,950

Converted Mk1 TSO currently in store at Winkworth.

Large bar area with longitudinal bench seating.

Commonwealth bogies with thick tyres.

Vacuum braked. Ideal for static conversion,  
or overhaul for operation.



### Komatsu RRV £12,500

Rail wheel brake conversion fitted. In working condition, recently in use, but hydraulic pump needs attention.

### Signalling Equipment:

Westinghouse Type 63 point machines. We have several of these for disposal, price £500 to £1000 depending on condition.- Post Mounted telephones: with push button handset, as new condition, 40 available £30-00,- LED Ground signals, 2 and 3 aspect, 50 available, £65-00-Shelf type relays: a very large selection of various types £30 each.

All prices subject to VAT,

Contact: [tim.oaks@e-v-r.com](mailto:tim.oaks@e-v-r.com), 07768 834530 /01298 22320 evenings







One offs, small batches, or quantity  
Call us to discuss your requirements

17d-engineering.co.uk 01629 825070

## JM Steam Engineering Ltd



Locomotive repair, overhaul and maintenance –  
Pattern making – Machining – 3D CAD design –  
CNC plasma/laser/waterjet – Hot Riveting –  
Fabrication – Consultation.

We pride ourselves on our commitment to quality and craftsmanship, ensuring each project reflects our deep respect for steam locomotive heritage while utilizing modern methodologies.

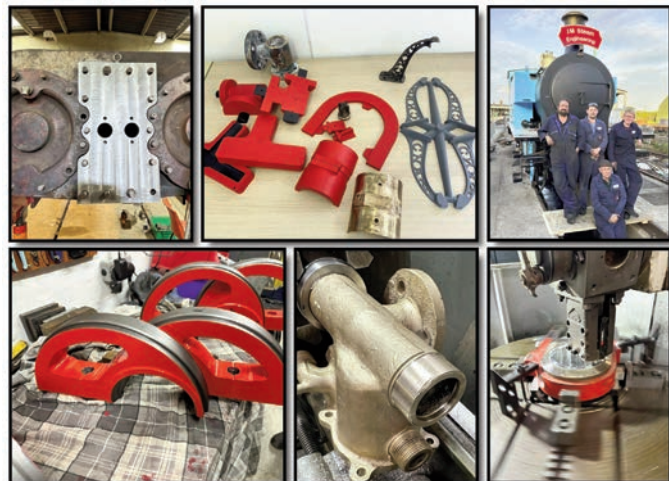

Currently recruiting heritage railway trained staff:  
Please email CV to address below.

EMAIL: [enquiries@jmsteamengineering.co.uk](mailto:enquiries@jmsteamengineering.co.uk)

TELEPHONE: 07713 019465

## Refractories & High Temperature Insulation Materials

# VITCAS®



- Premium IP Luting Compound for sealing white metal bearings.
- Fire Bricks and Refractory Castables for the brick arch.
- Ceramic Fibre Insulation for boilers.



Bristol  
0117 9117895  
[www.vitcas.com](http://www.vitcas.com)



## w.h.tildesley Ltd

Drop Forging Specialist



# LOCOMOTIVE FORGINGS

► SPECIALIST MATERIALS

► COMPLEX FORGING SHAPES

► SMALL BATCHES A SPECIALITY

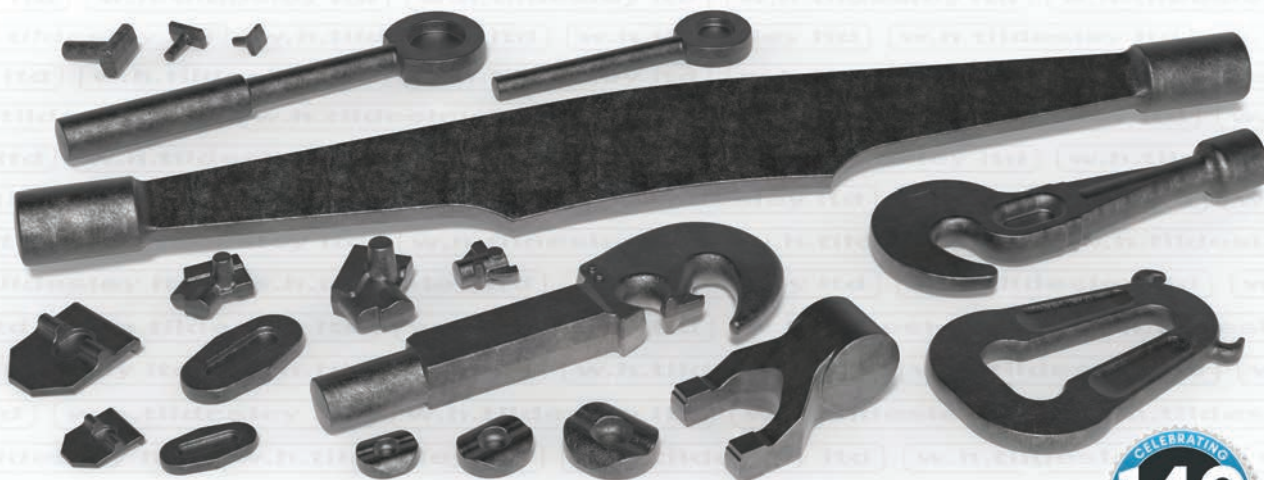

ENGINEERING SOLUTIONS SINCE 1874



[www.whtildesley.com](http://www.whtildesley.com) | tel: +44 (0)1902 366440 | fax: +44 (0)1902 366216 | email: [sales@whtildesley.com](mailto:sales@whtildesley.com)